



## 482 Pitt Street, **HAYMARKET**

**Fantastic Retail or Office Opportunity Situated Minutes from Central Railway Station**

### The Location

482 Pitt Street is located at the southern end of Sydney CBD, near the busy coach terminal at Central Station. Central Railway Station is recognised as the largest, busiest and most iconic railway station in NSW. It functions as the main transport terminal for NSW and services almost all lines on the Sydney Trains network.

### The Offering

The property is located on the eastern side of Pitt Street and on the North West boundary of Central Station, between George St & Eddy Avenue, prime position for capitalising on the vast number of commuters passing through daily.

### STATION & PASSENGER STATISTICS:

- Ranked as the #1 busiest station in NSW
- Over 5,800,000 passenger movements monthly

### USE TYPE:

All uses STCA

### PROVISIONS:

- 63 Amps, Single (1) Phase Power
- 93.1m<sup>2</sup> (approx.)
- Nil Trade Waste
- Nil Exhaust

### LEASE TERM:

Three (3) Years



**Lvl/Suite**  
Shop



**NLA**  
93 m<sup>2</sup>



**Rent**  
/m<sup>2</sup> Net



**Rent Review**  
To be advised



**Term**  
To be advised



**Available**  
Now

NOTE: All rentals and outgoings are exclusive of GST

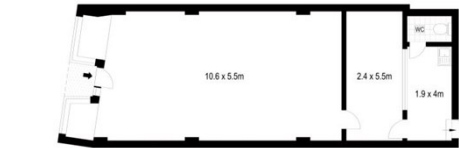

0 1 2 3 4 5



482 Pitt Street, Sydney



### Contact

**Sally Vince**

rcleasing@ciaustralia.com.au

**Michelle Perez**

mperez@ciaustralia.com.au

[ciaustralia.com.au](http://ciaustralia.com.au)

