



Eddy Avenue Retail Precinct Central Railway Station, SYDNEY

Fantastic retail opportunity in NSW's busiest, most iconic Railway Station

The Location

Central Railway Station is located at the southern end of Sydney's CBD, and is recognised as the largest, busiest and most iconic railway station in NSW. Central Railway Station functions as the main transport terminal for NSW and services almost all lines on the Sydney Trains network.

The Eddy Avenue retail precinct is located on the northern boundary of Central Railway Station, between Elizabeth Street and Pitt Street, prime position for capitalising on the vast number of commuters passing through daily.

The Offering

Shop 8 is ideally located on the southern side of the Eddy Avenue strip, boasting superior street exposure, allowing vendors to capitalise on the steady flow of commuters in this busy retail precinct.

STATION & PASSENGER STATISTICS:

- Ranked as the #1 busiest station in NSW
- Over 5,800,000 passenger movements monthly

USE TYPE:

All uses STCA

PROVISIONS:

- Power TBC
- Trade Waste TBC
- Exhaust TBC

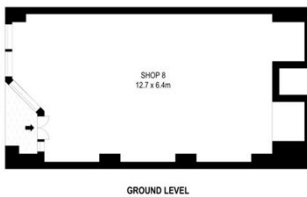

Shop 8 Central Railway Station, Sydney



Lvl/Suite
Ground Shop 8

Rent
/m² Gross

Term
To be advised

NLA
85 m²

Rent Review
To be advised

Available
Now

NOTE: All rentals and outgoings are exclusive of GST

Contact

Sally Vince
svince@ciaustralia.com.au

RailCorp
02 8238 0000
rcleasing@ciaustralia.com.au

ciaustralia.com.au

