



## Eddy Avenue Retail Precinct Central Railway Station, **SYDNEY**

**Situate your business within NSW's busiest, most iconic Railway Station**

### The Location

Central Railway Station is located at the southern end of Sydney's CBD, and is recognised as the largest, busiest and most iconic railway station in NSW. Central Railway Station functions as the main transport terminal for NSW and services almost all lines on the Sydney Trains network.

The Eddy Avenue retail precinct is located on the northern boundary of Central Railway Station, between Elizabeth Street and Pitt Street, prime position for capitalising on the vast number of commuters passing through daily.

### The Offering

Shop 7A is ideally located on the corner of the Eddy Avenue strip, opposite Belmore Park and the Eddy Avenue bus interchange. Take advantage of the sites superior street exposure and capitalise on the steady flow of commuters.

### STATION & PASSENGER STATISTICS:

- Ranked as the #1 busiest station in NSW
- Over 5,800,000 passenger movements monthly

### USE TYPE:

All uses STCA

### PROVISIONS:

- Power TBC
- Trade Waste TBC
- Exhaust TBC

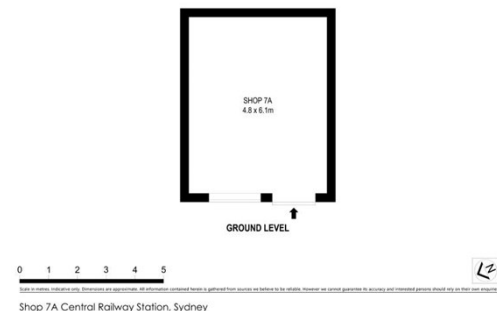

Shop 7A Central Railway Station, Sydney

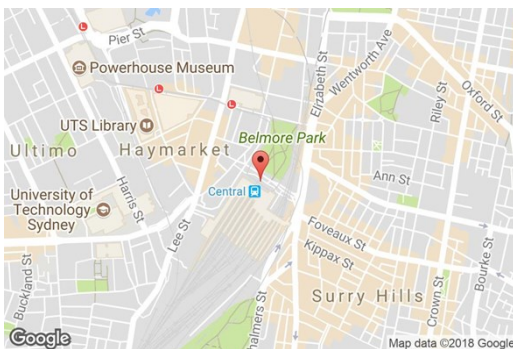
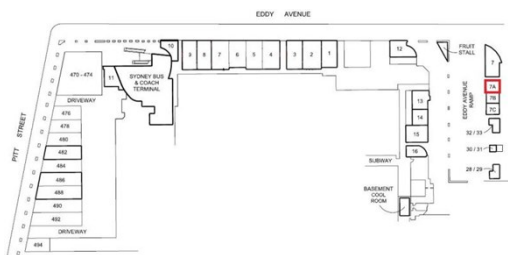

**Lvl/Suite**  
Ground Shop 7A

**NLA**  
30 m<sup>2</sup>

**Rent**  
/m<sup>2</sup> Gross

**Rent Review**  
To be advised

**Term**  
To be advised

**Available**  
Now

NOTE: All rentals and outgoings are exclusive of GST

### Contact

**Sally Vince**  
rcleasing@ciaustralia.com.au

**RailCorp**  
02 8238 0000  
rcleasing@ciaustralia.com.au

[ciaustralia.com.au](http://ciaustralia.com.au)

